

Rubber foam insulated female and male reducers

F...RPCL



Description

The reducers in the duct ventilation and air-conditioning systems serve the purpose of increasing or decreasing the pressure in the air supply system. They are available in two versions: A - male end version (e.g. F09-RPCL-125-100) to be joined on both sides with the ventilation spiral ducts; B - female-male version (e.g. F09-RPCFL-125-100) in which the smaller diameter enters into the round duct, and the larger diameter overlaps another fitting – most frequently the T-piece.

Marking example

Product code: **F09 - RPCL - - 125 - 100**

rubber thickness Q:

- 09
- 13
- 19
- 25

type

male-male

RPCL

female-male

RPCFL

sheet:

- galvanised
- stainless steel
- aluminium

K
A

diameter

- d₁
- d₂

Dimensions

RPCFL

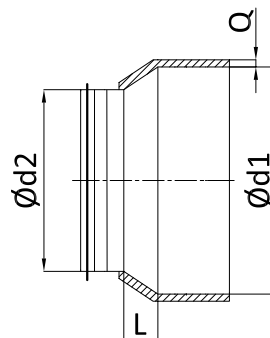

RPCL

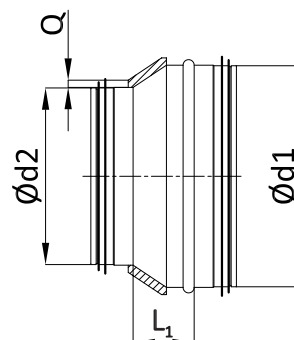

$\varnothing d_{1\text{ nom}}$ [mm]	$\varnothing d_{2\text{ nom}}$ [mm]	L [mm]	L ₁ [mm]
100	80	10	18
125	80	22	28
	100	12	22
150	100	35	35
	125	30	30
160	80	15	48
	100	30	37
	125	17	26
	150	30	30
200	100	50	58
	125	37	46
	150	35	35
	160	20	26
250	125	40	70
	150	60	60
	160	45	53
	200	25	31

Rubber foam insulated female and male reducers

F.-RPCL

Technical data

