

Telescopic air valves

ELZ-I



Description

ELZ-I telescopic air valves with thermal insulation supply fresh air to indoor spaces. One end of the ELZ-I valve has an outdoor air intake vent with louvers and a protective mesh. The other — indoor — end has a round air supply valve with an adjustable opening. The opening size can be adjusted smoothly by rotating the disk closure, or in a three-step adjustment procedure with a pull cable.

The outdoor air intake vent and the air supply valve are connected via a telescopic tube.

The thermal insulation cladding is installed inside the tube and on the disk closure.

The ELZ-I telescopic air valve is designed for installation in the outer wall of the building. The maximum wall thickness is 400 mm. The minimum ceiling clearance for the ELZ-I valve is 100 mm.

The area to be ventilated should be provided with two ELZ-I valves aligned opposite to each other for the best air flow rate. The outdoor air intake vent is finished in grey and the air intake valve is finished in white.

The ELZ-I telescopic air valves are intended for single-family houses and apartments in multi-family buildings.

Product code example

Product code: **ELZ-I - aaa**

type _____
 Ød _____

Dimensions

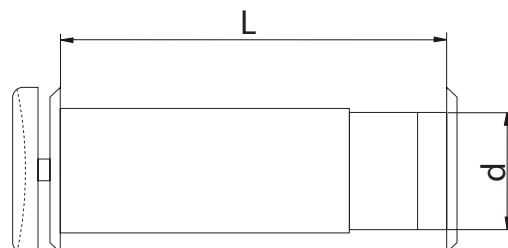

Technical specifications

Product code	Clear surface area (cm ²)	d (mm)	L (mm)	Sound insulation at 250 Hz
ELZ-I-100-00	35	105	260/400	22.3
ELZ-I-100-05	35	105	260/400	39.5

Telescopic air valves

ELZ-I

Technical specifications

Sound insulation chart for ELZ-I-100-0

Hz	dB
100	33.1
125	35.3
160	32.3
200	27.2
250	22.3
315	14.6
400	23.4
500	23.6
630	19.9
800	29.1
1000	30.7
1250	33.9
1600	37.5
2000	43.0
2500	44.1
3150	46.1

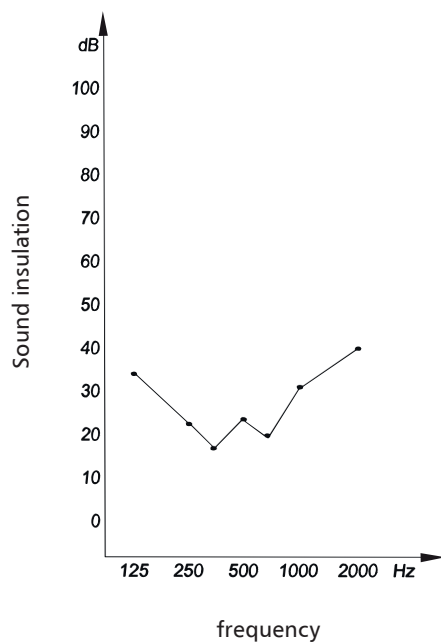

Sound insulation chart for ELZ-I-100-05

Hz	dB
100	33.1
125	35.3
160	32.3
200	27.2
250	22.3
315	14.6
400	23.4
500	23.6
630	19.9
800	29.1
1000	30.7
1250	33.9
1600	37.5
2000	43.0
2500	44.1
3150	46.1

